

DAVEFAB

BESPOKE | MOTORSPORT | FABRICATION

MX5/Miata ECU Splash Guard

Mk3 / NC

D136-A001

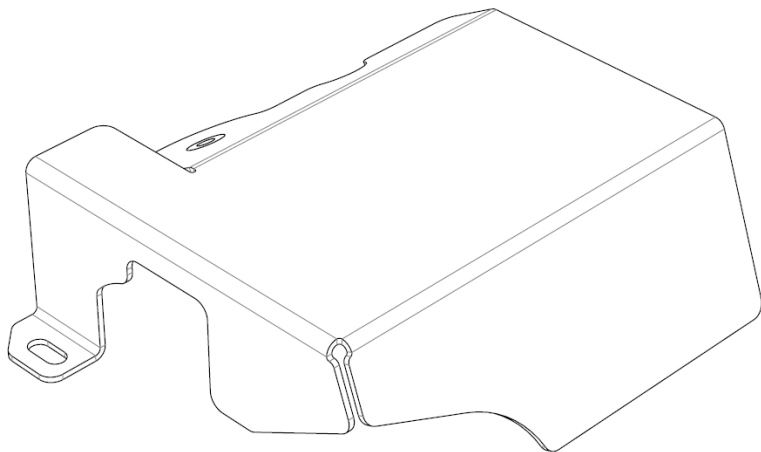

DAVEFAB

BESPOKE | MOTORSPORT | FABRICATION

Carton Contents:

1x D136-B001 - NC ECU Splash Guard

1x D136-B002 - Fitting Kit

- 1x Instruction Leaflet
- 1x Sticker
- 1x 530132 - M6 Nylock Nut

DAVEFAB

BESPOKE | MOTORSPORT | FABRICATION

Installation Instructions

The DaveFab ECU Splash Guard is designed to be fitted if the factory air intake has been removed, exposing the ECU wiring and connectors.

1. Install the DaveFab ECU Splash Guard

- 1.1. Remove the M6 nut on the left side of the ECU housing.
- 1.2. Locate the boss on the underside of the guard into the rubber mounting originally used to locate the airbox.
- 1.3. As you push the boss into the rubber mounting align the slotted tab over the thread on the left side of the ECU.
- 1.4. Use the M6 nut supplied to secure the guard in place.

DAVEFAB

BESPOKE | MOTORSPORT | FABRICATION

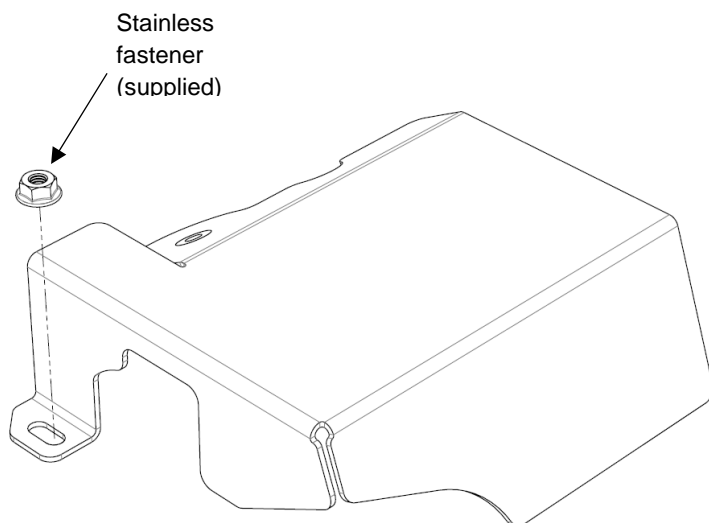

If you have any questions please let us know: info@davefab.com

Thanks for supporting DaveFab!