



# Dual Air Horn Kit

PART# 902-170

## Installation Instructions

### For: Mazda MX-5 Miata

1990–1998.....	pg 2.	2006–2015.....	pg 4.
1999–2005.....	pg 3.	2016+ .....	pg 8.

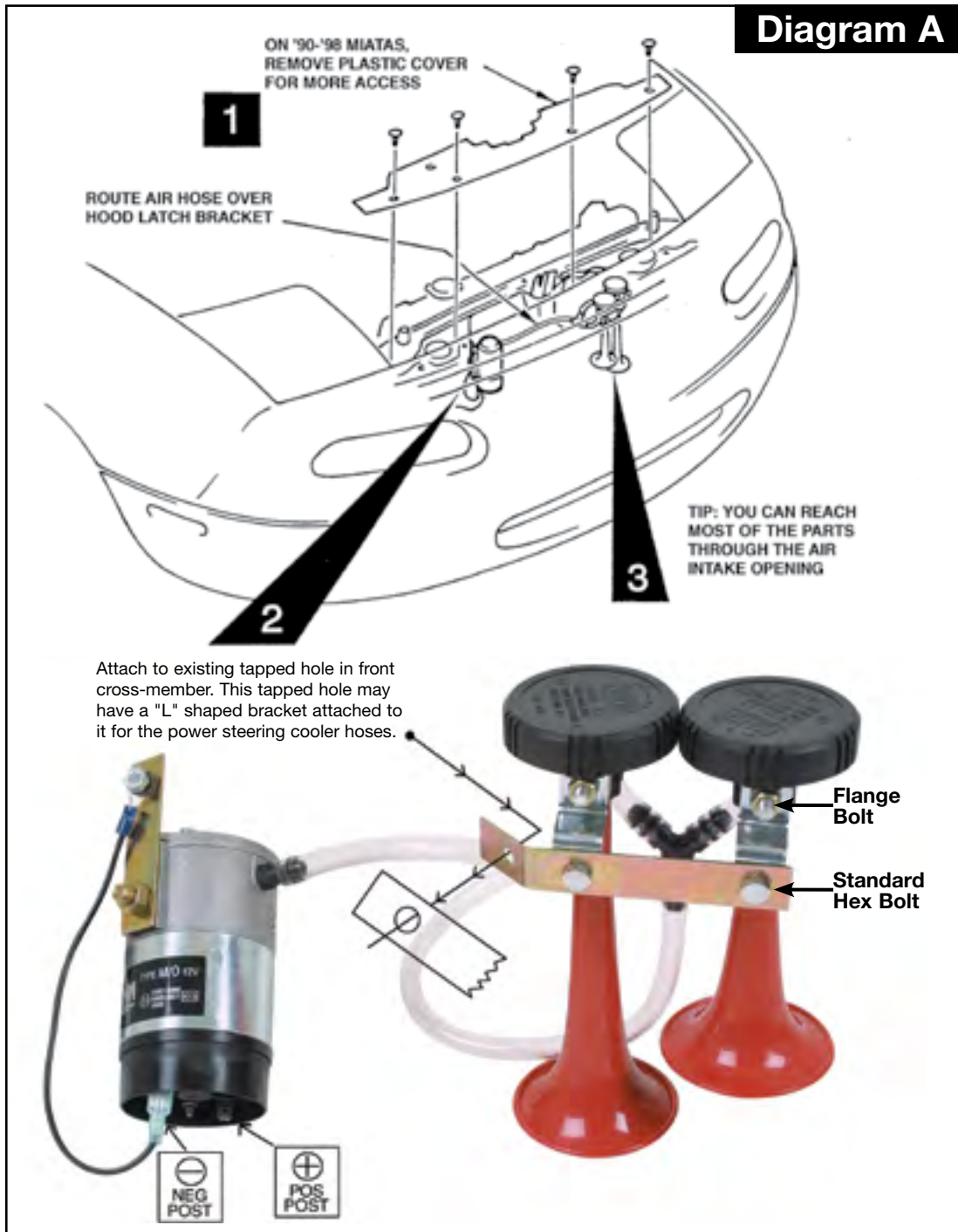



# Dual Air Horn Kit

PART# 902-170

## Installation Instructions

### For: 1990–1998 Mazda MX-5 Miata

440 Rutherford St. Goleta, CA 93117  
1-800-642-8295 • FAX 805-692-2525 • [www.MossMiata.com](http://www.MossMiata.com)

#### Tools required:

- 10mm wrench
- Phillips screwdriver

#### Instructions:

1. With a Phillips screwdriver, remove the plastic shielding surrounding the hood latch in front of the radiator (Diagram A, **1**).
2. With a 10mm wrench, remove the bolt that holds the stock horn bracket to the inner support.
3. Remove the bracket and horn completely by unplugging the wire that leads to the horn. On the back of the horn, remove the center nut and horn from the bracket.
4. Using the supplied bolt, nut, and lock washer, attach the air compressor and ground wire to the bracket (Diagram A, **2**).
5. Plug the black ground wire into the negative terminal on the bottom of the compressor. Plug the stock green-with-red wire to the positive terminal on the bottom of the compressor.
6. Using the old bolt and new provided lock washer, replace the horn bracket, with the compressor now attached, to the old location.
7. Using the provided nuts, bolts, and lock washer, install the air horns to the new horn bracket (Diagram A, **3**).
8. Cut two 2" long pieces of air hose from the length provided. Attach one end to the "Y" connector and the other to the nipple on the air horns (Diagram A, **3**). Attach the remaining length of air hose to the "Y" connector and the other end to the nipple on the compressor. Route the air hose as shown in Diagram A, **1**.
9. Finally attach the air horns with their bracket to the inner support in the hole shown in Diagram A, **1**.

**NOTE:** On cars fitted with a power steering cooler, this hole will also be used to mount the cooler clip. Simply remove the existing bolt, place the Air horn bracket on top of the clip and use the new bolt and washer included in the kit.



# Dual Air Horn Kit

PART# 902-170

## Installation Instructions

### For: 1999–2005 Mazda MX-5 Miata

440 Rutherford St. Goleta, CA 93117  
1-800-642-8295 • FAX 805-692-2525 • [www.MossMiata.com](http://www.MossMiata.com)

#### Tools required:

- 10mm wrench
- Phillips screwdriver

#### Instructions:

1. With a 10mm wrench, remove the bolt that holds the stock horn bracket to the inner support.
2. Reach through the front air intake opening and remove the bracket and horn completely by unplugging the wire that leads to the horn.
3. Using the supplied bolt, nut, and lock washer, attach the air compressor and ground wire to the new compressor bracket. (Diagram A, **2**).
4. Plug the black ground wire into the negative terminal on the bottom of the compressor. Plug the stock green-with-red wire into the positive terminal on the bottom of the compressor.
5. Using the old bolt and the new provided lock washer, install the compressor, now attached to its new bracket, to the old location.
6. Using the provided nuts, bolts, and lock washer, install the air horns to the new horn bracket (Diagram A, **3**).
7. Cut two 2" long pieces of air hose from the length provided. Attach one end to the "Y" connector and the other to the nipple on the air horns (Diagram A, **3**). Attach the remaining length of air hose to the "Y" connector and the other end to the nipple on the compressor. Route the air hose as shown in Diagram A, **2**.
8. Working through the front air intake opening, attach the air horns with their bracket to the inner support in the hole shown in Diagram A, **2**.

**NOTE:** On cars fitted with a power steering cooler, this hole will also be used to mount the cooler clip. Simply remove the existing bolt, place the air horn bracket on top of the clip and use the new bolt and washer included in the kit.



# Dual Air Horn Kit

PART# 902-170

## Installation Instructions

### For: 2006–15 Mazda MX-5 Miata

440 Rutherford St. Goleta, CA 93117

1-800-642-8295 • FAX 805-692-2525 • [www.MossMiata.com](http://www.MossMiata.com)

#### Tools required:

- Phillips screwdriver
- 8mm, 10mm and 21mm sockets
- 8mm and 10mm combination wrenches
- Sandpaper
- Scissors

1. Set the hand brake, put in gear or park. Chock the rear wheels. Jack the front of the vehicle up and place it on jack stands. Do not work on the vehicle while it is on the jack. Remove the drivers' side front wheel using a 21mm socket. Use a Phillips screwdriver to remove the eight plastic fasteners securing the drivers' side, front inner fender liner to the body of the vehicle. Use an 8mm socket to remove the three screws securing the drivers' side, front inner fender liner to the front bumper cover. Remove the front fender liner.

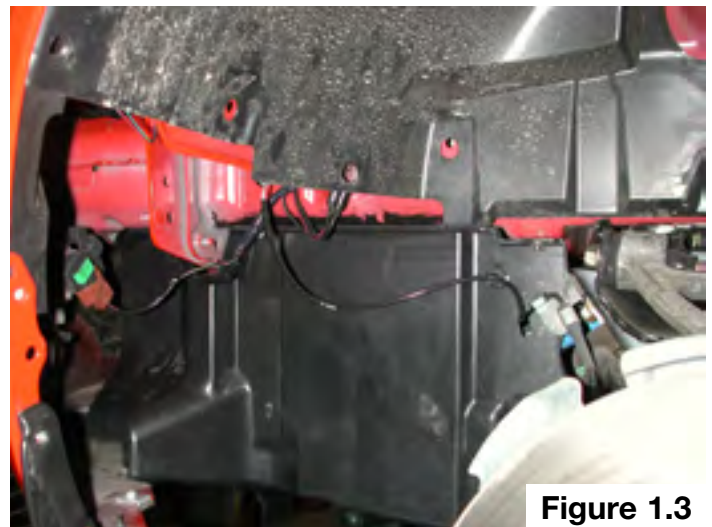
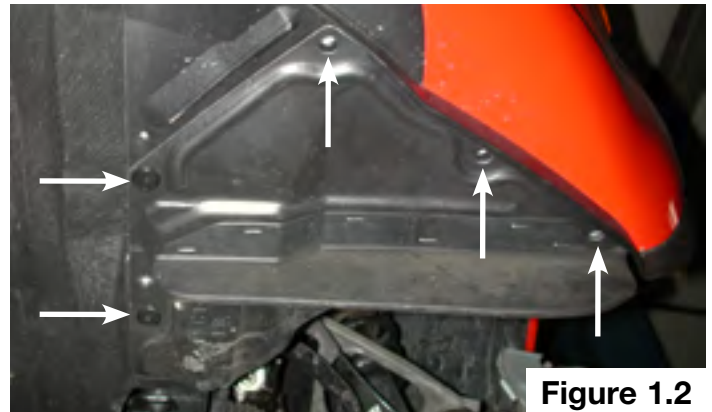
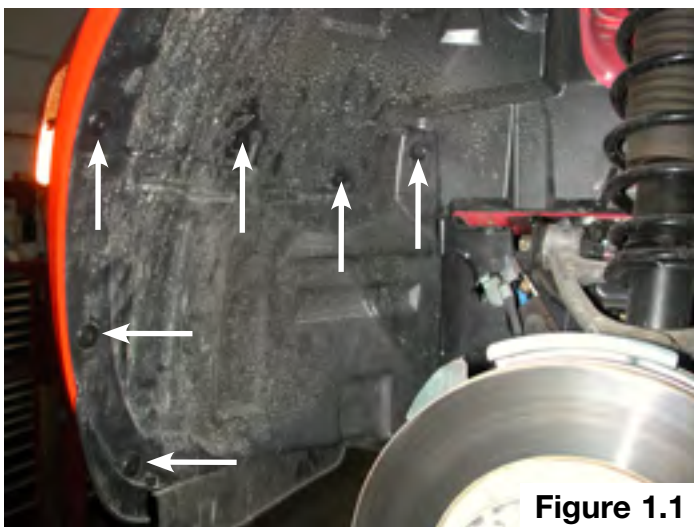

2. The stock horn is located on the drivers' side of the front bumper. Reach through the front bumper cover and disconnect the horn wire. If your arm will not fit through the bumper cover you will need to remove the screws holding the splash shield to the bumper cover and reach between them to access the connector. From in the wheel well area, remove the horn wire from the clip securing it to the body. If you have trouble unclipping the wire, cut the clip to free it. Pull the connector into the wheel well area and let it hang.



3. Gather the two horns, two square head M6 bolts, two M6 lock washers, two M6 nuts and the horn bracket with the bend in it. Attach the horns to the bracket with the bolts, lock washers and nuts as pictured. The bent tab of the horn bracket will point down and be on the left side, with the smaller horn on the right, and the larger horn in between the bent tab and the smaller horn.



4. Gather the clear hose, the plastic Y-fitting and the horn assembly. Use scissors and cut two 3" pieces of hose. Attach the 3" pieces of hose to the Y-fitting. Attach the other ends of the hoses to the horns.



## Installation Instructions

5. Gather the air pump, the ground strap, and the last square head M6 bolt. Attach the female spade connector of the ground strap to the male spade on the (-) negative side of the air pump. Slip the square head M6 bolt into the air pump.

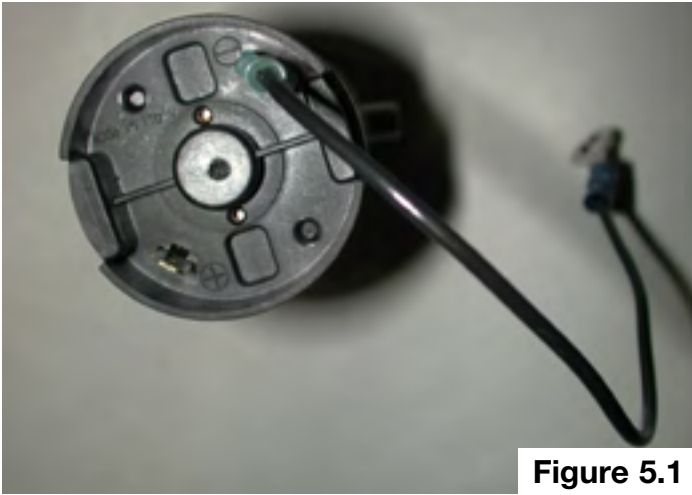

**Figure 5.1**

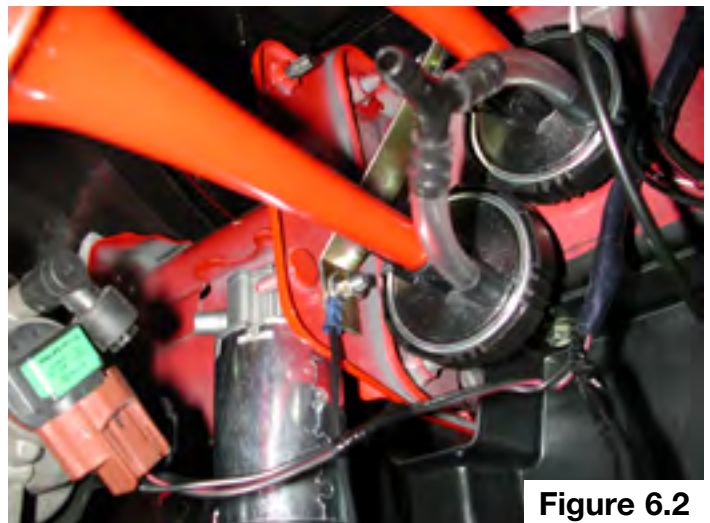

**Figure 5.2**

6. Gather the air pump assembly, the horn assembly, a M6 lock washer and a M6 nut. Looking through the fender well area of the vehicle toward the front bumper you will notice a plate with two holes near where the front bumper bolts to the vehicle. Use sandpaper to remove the paint around the bottom hole on the back side of the plate. This will aid in grounding the air pump. Slip the air pump with the square bolt attached, up in front of the plate. Slip the bolt through the bottom hole. On the back side of the plate, slip the horn assembly onto the bolt protruding through the hole. Next, slip the ground strap over the bolt, and then the lock washer and nut. Tighten the nut using a 10mm combination wrench. The spade terminals of the air pump should be pointing down. The horns can be pointed left, toward the outside of the vehicle or down.

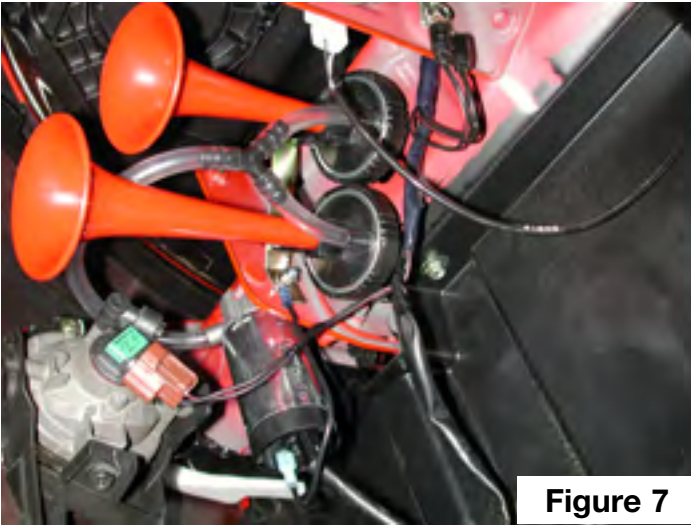

**Figure 6.1**



**Figure 6.2**

7. Gather the rest of the clear hose and attach one end to the air pump outlet. Route the hose over the fog light, in between the two horns to the Y-fitting. Cut the hose to length so that the hose will not rub on anything sharp that may puncture it, but don't cut it so short that it will kink when it is installed. The hose should end up approximately 10" if the horn is pointed to the left (outside of the vehicle). Attach the hose to the Y-fitting. Now attach the horn wire from the vehicle to the (+) positive side of the air pump. Test the horn.



**Figure 7**

8. Finally, reinstall the fender liner and wheel. Torque the lug nuts to 65-87 ft lb.

Enjoy your dual air horns!



# Dual Air Horn Kit

PART# 902-170

## Installation Instructions

### For: 2016+ Mazda MX-5 Miata

440 Rutherford St. Goleta, CA 93117  
1-800-642-8295 • FAX 805-692-2525 • [www.MossMiata.com](http://www.MossMiata.com)

#### Tools required:

- Small flathead screwdriver
  - 8mm, 10mm, 12mm, 13mm, and 21mm sockets
  - 10mm and 12mm combination wrenches
  - Scissors
1. Set the hand brake, put in gear or park. Chock the rear wheels. Jack the front of the vehicle up and place it on jack stands. Do not work on the vehicle while it is on the jack. Remove the passenger side front wheel using a 21mm socket. Use a small flathead screwdriver to remove the plastic fasteners securing the passenger side, front lower fender liner to the body of the vehicle. Use an 8mm socket to remove the 4 screws. Remove the front fender liner.



**Figure 1**

2. There are two stock horns on the 2016+ Miata. One is located behind the front grill. Reach through the grill and remove the spade connector by pushing on the tab and pulling it off the terminal. You can also leave it connected and run both the stock and air horns together if desired.
3. The second horn is located in front of the front passenger wheel well.



**Figure 3.1**

Remove the spade connector by pushing on the tab and pulling it off the terminal. From in the wheel well area, remove the horn wire from the clip securing it to the body. If you have trouble unclipping the wire, cut the clip off. Pull the connector into the wheel well area and let it hang. You will use this wire to connect to the air pump. Remove the 12mm bolt and nut and remove the stock horn from the vehicle. Leave the small steel bracket in place.



**Figure 3.2**

4. Gather the two horns, two square head M6 bolts, two M6 lock washers, two M6 nuts and the horn bracket with the bend in it. Attach the horns to the bracket with the bolts, lock washers and nuts as pictured. The bent tab of the horn bracket will point down and be on the left side. The shorter horn will be on the right.



**Figure 4**

5. Gather the plastic hose, the Y-fitting, and the air horn assembly. Use the scissors to cut 2 x 3" pieces of hose. Attach the hoses to the Y-fitting and the air horns as shown. Slip the remainder of the hose onto the Y-fitting and leave the other end unconnected for now.



**Figure 5**

6. Gather the small metal bracket, ground wire, and the M6 bolt, lock washer and nut. Attach the air horns as shown, with the air horns facing towards the front center of the bumper. Slip the small straight metal bracket over the bolt and the ground wire and secure everything with a lock washer and nut. Leave slightly loose to allow for adjustment.

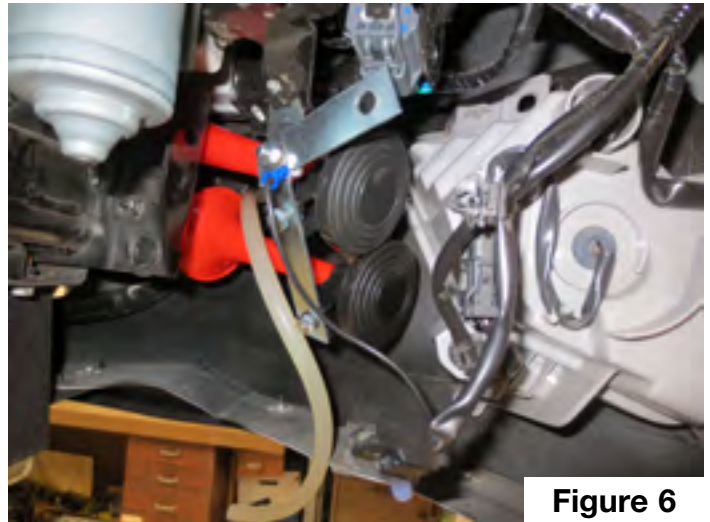

**Figure 6**

7. Gather the air pump assembly, and the M8 bolt, lock washer and nut. Slide the head of the M8 Bolt into mounting tab on the air pump. Mount the air pump to the small straight bracket and secure with the M8 lock washer and nut. Position everything so the spade terminals of the air pump point down. Ensure the ground wire and stock horn spade terminal will reach the terminals on the air pump. Attach the stock horn wire to the (+) terminal and the ground wire to the (-) terminal on the air pump.



**Figure 7**

## Installation Instructions

---

8. Once everything is in the desired position, tighten down the M8 and M6 nuts. If necessary, the brackets can be bent a bit by hand a bit to achieve a better fit in the car and clearance from the fender liner.



**Figure 8**

9. Run the hose to the air pump. Cut the hose to length for a cleaner installation. Be sure the hose is run with smooth bends and no kinks, and not close to anything it might rub on and damage the hose.
10. Test your horns for proper operation and reinstall the fender liner and wheel. Torque the wheel nuts to factory specs 65-87 ft lb.

Enjoy your dual air horns!

***Although every effort has been made to ensure the accuracy and clarity of this information, any suggestions that you may have that will improve the information (especially detailed installation notes and photos) are welcome. These instructions were developed and written by Moss Technical Support. If you have any questions or difficulties with your installation of this product, telephone 800-667-7872 between 7:00 a.m. and 4:00 p.m., Pacific Time for assistance.***

**Moss Motors, Ltd.**  
440 Rutherford Street, Goleta, California 93117  
In the US & Canada Toll Free (800) 667-7872  
LOCAL (805) 681-3400 FAX (805) 692-2510



**Moss Europe Ltd.**  
Hampton Farm Industrial Estate  
Hampton Road West, Hanworth Middlesex, TW13 6DB  
In the UK: 020-8867-2020 FAX: 020-8867-2030