

**INSTALLATION
(CONTINUED)**

5. **For Super Silicone Wiper Blades Only;** Run the PIAA Super Silicone blades dry for 5 minutes for final windshield preparation. This applies an initial silicone coating to the windshield. Periodically run the PIAA Super Silicone Wiper Blades dry to maintain an even silicone coating.

6. Replacement Periods
- a. Super Silicone Wiper Blades – Replace yearly or when damaged.
 - b. Graphite Wiper Blades – Replace every 6-8 months or when damaged.

7. Keeping the windshield and wiper blades clean will prolong the life of your wiper blades.

Record date of installation for your records.
PIAA Wiper Blades should be replaced when wiper performance decreases.

month day year

/ /

Thank You
PIAA

**WARRANTY
GRAPHITE**

PIAA Corporation, USA ("PIAA") warrants the Super Graphite Wiper Blades to be free from defects in workmanship and materials under normal use for one year from the date of purchase.

EXCLUSIONS

This Limited Warranty specifically excludes damage resulting from "acts of nature", misuse, abuse, neglect, alteration, modification, improper installation.

The graphite rubber is considered a consumable and is therefore excluded from the provision of the Limited Warranty.

Except for the Limited Warranty stated above, there are no warranties of PIAA products or any part thereof, whether expressed or implied. Any implied warranty of merchantability or any warranty of fitness for a particular purpose is expressly disclaimed. Some states do not permit the disclaimer of implied warranties.

REPAIR AND REPLACEMENT

If a PIAA Super Graphite Wiper Blade is suspected of being defective, it must be returned to an authorized PIAA dealer for warranty inspection. Removal, installation, or reinstallation costs are not covered by this Limited Warranty.

**WARRANTY
SUPER SILICONE/SUPER SPORZA**

PIAA Corporation, USA ("PIAA") warrants the Super Silicone Wiper Blades to be free from defects in workmanship and materials under normal use for one year from the date of purchase.

EXCLUSIONS

This Limited Warranty specifically excludes damage resulting from "acts of nature", misuse, abuse, neglect, alteration, modification, improper installation.

The silicone rubber is considered a consumable and is therefore excluded from the provision of the Limited Warranty.

Except for the Limited Warranty stated above, there are no warranties of PIAA products or any part thereof, whether expressed or implied. Any implied warranty of merchantability or any warranty of fitness for a particular purpose is expressly disclaimed. Some states do not permit the disclaimer of implied warranties.

REPAIR AND REPLACEMENT

If a PIAA Super Silicone Wiper Blade is suspected of being defective, it must be returned to an authorized PIAA dealer for warranty inspection. Removal, installation, or reinstallation costs are not covered by this Limited Warranty.

PIAA CORPORATION, USA

3004 NE 181st Avenue
Portland, Oregon 97230
Telephone: 503.489.6666
Fax: 503.489.6600
Web: www.piaa.com

**PIAA
Wiper Blades**

Installation Manual

Thank you very much for purchasing PIAA Wiper Blades.
Please read this entire manual before installation and use of this product.

Most popular adapter to fit most vehicles.

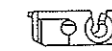

C1/C11 - Most popular hook style adapter and 3/16" side-lock, pin-style application



C2/C6 - Dodge, Audi, Chrysler



There are 2 types which vary in thickness, verify fit before installation. The thickest one is for 28" (700mm) blade only.

C6 only for 28" (700mm)



C3 - Audi, Citroen, Opel, Peugeot, Porsche, Volkswagen, Volvo



C4 - Citroen, Dodge, Renault, Jeep

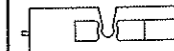

C5 - BMW

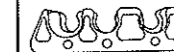

C15 - 1/4" and 3/16" side-lock, pin-style application

To ensure optimal performance, contact your local PIAA Authorized Dealer for assistance.

CONTENTS

One PIAA Wiper Blade



Seven Adapters
Adapter content may vary depending on application.

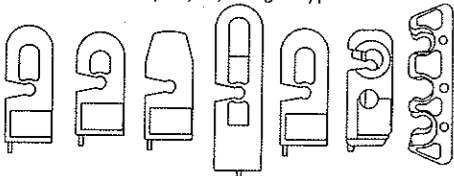

One Windshield Preparation Pack
Super Silicone and Super Sparza Wipers only.

WIPER BLADE ANATOMY

Primary Stay: Enhanced aerodynamic design to reduce windlift.

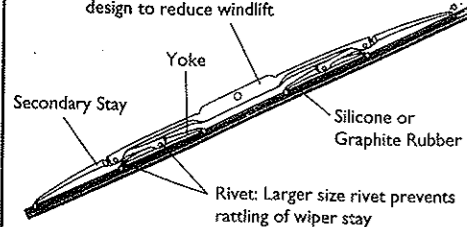

Rivet: Larger size rivet prevents rattling of wiper stay

PREPARATION

CAUTION
BEFORE BEGINNING INSTALLATION, PARK VEHICLE IN SAFE LOCATION, TURN OFF ENGINE AND SET PARKING BRAKE.

1. Remove old wiper blades.

CAUTION
WIPER BLADE ARMS ARE SPRING LOADED, MAKE SURE THEY DO NOT IMPACT THE WINDSHIELD, THIS MAY CAUSE DAMAGE.

2. Wash windshield thoroughly with soap and water or a glass cleaner.

3. **For Super Silicone Wiper Blades Only;** apply the windshield treatment solution. Remove the windshield treatment towel from its packet. Wipe the entire windshield with windshield treatment towel. Let the windshield treatment solution dry on the windshield for 10 minutes, then wipe windshield with a clean, dry or slightly damp towel.

CAUTION

- Use the windshield treatment packet only as intended.
- Windshield treatment packet not for consumption.
- In case of consumption, seek medical attention.
- Avoid contact with skin.
- Avoid eye contact.
- In case of eye contact, flush with water and seek medical attention if irritation persists.
- Keep windshield treatment packet away from open flames.
- Do not store in direct sunlight.
- Store under 40°C / 105°F.
- If cleaner contacts a painted surface, clean with soap and water immediately.

Windshield treatment pack chemical contents:
isopropyl alcohol > 98% / ethanol (solution of silicone) < 2%

INSTALLATION

Hook Style Wiper Arms

1. Choose the correct wiper blade adapter from the adapter pack (see application guide).

2. Test fit the adapter into the wiper arm to check fit. The correct adapter will "snap" into place.

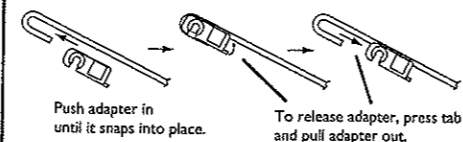

3. Once proper adapter is identified, press the adapter into the PIAA wiper blade. The adapter will snap into place on the pin in the center of the primary stay.

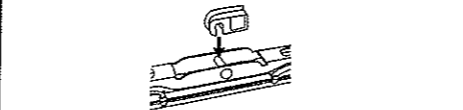

4. Install PIAA wiper blade onto wiper arm.

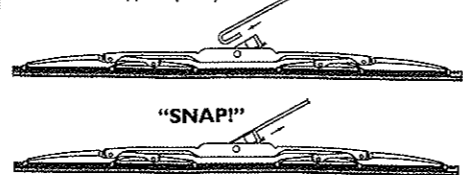

INSTALLATION

3/16" Side-Lock, Pin-Style Wiper Arms

A. For 3/16" side lock pin style wiper systems. Adapter C11 only.

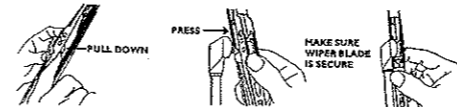

3/16" and 1/4" Side-Lock, Pin-Style Wiper Arms

A. For 3/16" and 1/4" side lock pin style wiper systems. Adapter C15 only.

B. Insert wiper arm pin through the correct sized hole in the wiper frame.

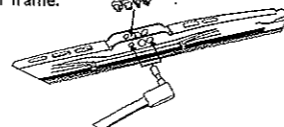

C. With wiper arm pin inserted all the way through the frame snap adapter C15 over center pin and wiper arm pin. Notice that adapter C15 has a larger and smaller receptacle side. Match the larger and smaller sides of the adapter with the larger and smaller holes in the frame.

D. Make sure adapter C15 "snaps" into place and that the wiper blade is securely fastened to the wiper arm. Also make sure the wiper blade is free to swivel on the wiper arm pin.



Adapter C15 may not work with some 3/16" wiper arms. If so, use adapter C11.